

COXREELS® EZ-SH Series “Super Hub™” spring driven hose reels, like the EZ-P Series, have a long history of dependable performance. The larger chassis and frame accommodate longer lengths and larger diameters of hose. Coxreels’ original Super Hub™ dual axle support system increases the stability during operation, reduces vibration and strengthens the structural integrity of the reel.

LOW PRESSURE

Models with hose are for air or water service with a maximum temperature 150° F. Models less hose can be used for air, water or oil.
Note: Do not exceed listed hose O.D. to obtain maximum length.

HOSE						LESS HOSE		SIZE INDEX
MODEL	I.D.	O.D.	FT.	PSI	APRX. LBS.	MODEL	APRX. LBS.	
EZ-SH-350	3/8"	5/8"	50	300	50	EZ-SHL-350	44	1
EZ-SH-375	3/8"	5/8"	75	300	68	EZ-SHL-375	59	2
EZ-SH-3100	3/8"	5/8"	100	300	71	EZ-SHL-3100	60	2
EZ-SH-450	1/2"	3/4"	50	300	54	EZ-SHL-450	46	1
EZ-SH-475	1/2"	3/4"	75	300	68	EZ-SHL-475	57	3
EZ-SH-4100	1/2"	3/4"	100	300	81	EZ-SHL-4100	66	3
EZ-SH-525	3/4"	1 1/16"	25	300	52	EZ-SHL-525	45	4
EZ-SH-550	3/4"	1 1/16"	50	300	69	EZ-SHL-550	56	5

MEDIUM PRESSURE

Reels are furnished with standard one wire braid hose suitable for air, water or oil applications. Hose exceeds SAE R1 specifications. Maximum temperature 250° F. **Note: Do not exceed listed hose O.D. to obtain maximum length.**

HOSE						LESS HOSE		SIZE INDEX
MODEL	I.D.	O.D.	FT.	PSI	APRX. LBS.	MODEL	APRX. LBS.	
EZ-MP-350	3/8"	1 1/16"	50	3000	65	EZ-MPL-350	53	1
EZ-MP-450	1/2"	1 3/16"	50	2500	67	EZ-MPL-450	53	6

HIGH PRESSURE

Reels are furnished standard with S.A.E. 100R16 #1 or #2 wire braid hose suitable for grease and hydraulic oil applications. Maximum temp. 250° F. **Note: Do not exceed listed hose O.D. to obtain maximum length.**

HOSE						LESS HOSE		SIZE INDEX
MODEL	I.D.	O.D.	FT.	PSI	APRX. LBS.	MODEL	APRX. LBS.	
EZ-HP-150	1/4"	9/16"	50	5000	64	EZ-HPL-150	53	6
EZ-HP-350	3/8"	1 1/16"	50	4000	65	EZ-HPL-350	53	7

REEL DIMENSIONS

Technical Data Sheets Available On Website

SIZE INDEX	W	H	L	X	Y	M	N
1	8 1/4"	21 1/4"	19 1/2"	6"	6"	4"	5"
2	8 1/4"	21 1/4"	24"	6"	6"	4"	5"
3	8 3/4"	25 1/2"	24"	6"	6"	4"	5"
4	9 3/8"	25 1/2"	19 1/2"	6"	6"	4"	5"
5	9 3/8"	25 1/2"	24"	6"	6"	4"	5"
6	8 3/4"	25 1/2"	19 1/2"	6"	6"	4"	5"
7	9 1/4"	25 1/2"	19 1/2"	6"	6"	4"	5"

Overall Dimensions Base Mounting Pattern

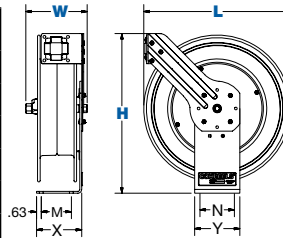

Double axle support with Super Hub™

EZ-SH, EZ-MP & EZ-HP SERIES :: REEL SPECIFICATIONS

SWIVEL

- External fluid path with machined from solid brass 90° full-flow NPT swivel inlet (Zinc plated steel swivel on HP models)
- Swivel Seals: NITRILE

DESIGN & STRUCTURE

- Sturdy single pedestal reel features Coxreels’ exclusive Super Hub™ dual axle support system
- Guide arm adjusts to wall, floor, vehicle & overhead positions
- Solid one piece, heavy gauge 1/4" steel base & support post for maximum stability
- 1" solid steel axle & lubricated precision bearings for smooth rotation

EZ-COIL RETRACTION

- **OUR PATENTED SAFETY SYSTEM THAT RETRACTS UP TO 80% SLOWER THAN CONVENTIONAL SPRING DRIVEN REELS**
- Enclosed factory tuned & matched cartridge-style spring motor
- Non-corrosive stainless steel spring, pawl & zinc plated ratchet
- Multi-position lock ratchet mechanism secures hose at desired length

SIGNATURE FEATURES

- Professional grade heavy duty steel construction
- Durable proprietary CPC™ powder coat process
- Rolled edges & ribbed discs provide strength & safety
- Leading 2-year manufacturer’s limited warranty
- Made in the U.S.A. - Sold & Supported Worldwide

POSSIBLE FIELDS OF APPLICATION

- Air/Water Services
- Pneumatic Tools
- Washdown
- Lubrication
- Service / Mechanic / Utility Vehicles
- Chemical Fluid Transfer
- General Industrial
- Manufacturing Plants & Facilities
- Maintenance, Repair & Operations
- Automotive & Fleet Service Centers

ACCESSORIZE YOUR REEL :: PG 17

- O-Rings & Swivels
- Mounting Brackets
- Hoses
- Assorted Reel Accessories



LET'S COMPARE

SPEED	Conventional SPRING DRIVEN REELS	EZ-COIL
WHIPPING	25 ft./sec.	5 ft./sec.
IMPACT	5-15 ft.	1 ft.
	500 ft./lbs.	0-1 ft./lbs.

Up To 80% Slower Retraction

Based on an independent evaluation performed by COXREELS. Depending on certain conditions, results may vary.